

AccuFill® PF BSM Kit

Prefilled Mixing and Saline Syringes for the Subchondroplasty® Procedure

AccuFill PF BSM Kit includes all components to hydrate and mix AccuFill BSM in a convenient, closed mixing system.

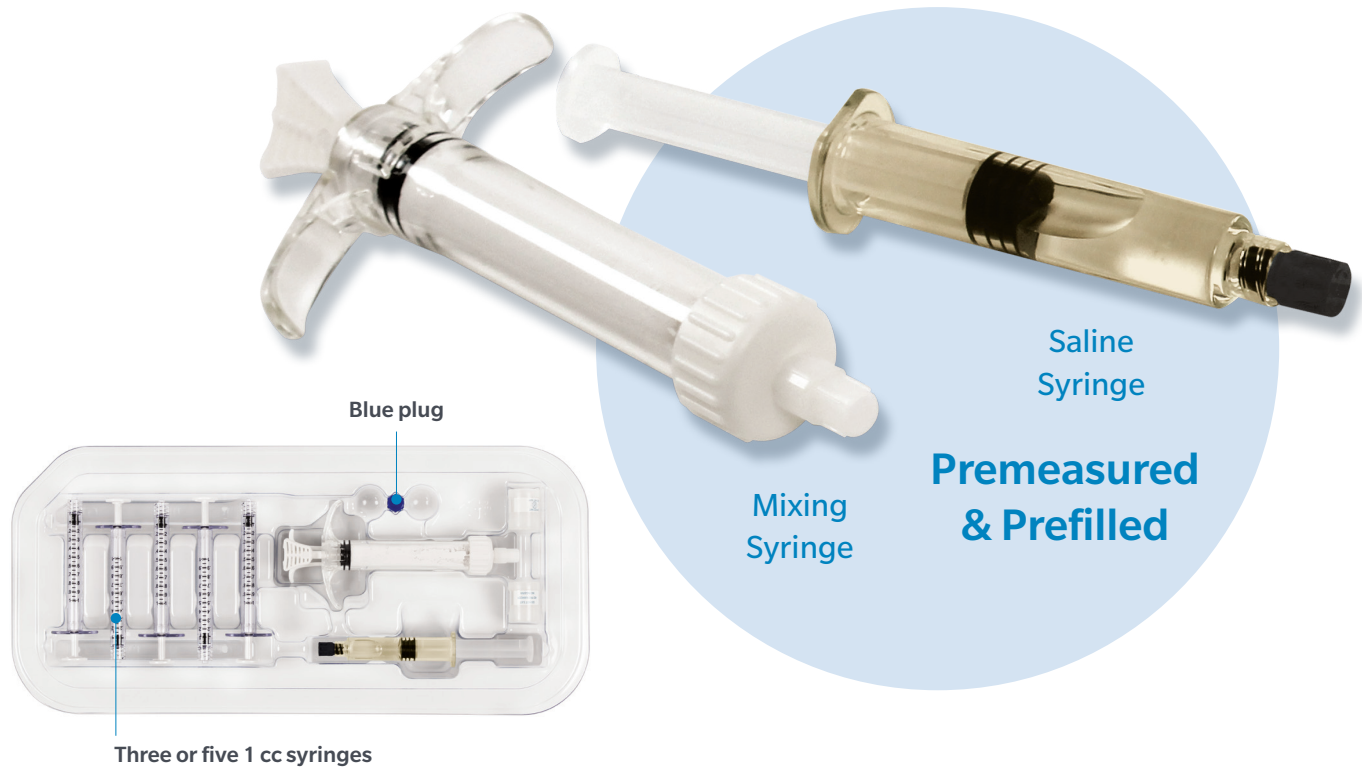

Prefilled	Consistent, reproducible hydration and mixing of AccuFill Bone Substitute Material (BSM)
Premeasured	Fewer procedural steps with user-friendly design and technique
Closed Mixing Syringe; closed transfer to injection syringes	Controlled mixing and delivery with no loss of material Multi-function syringe converts from mixing syringe to delivery syringe

AccuFill PF BSM is available kitted with a wide range of AccuPort® Cannulas

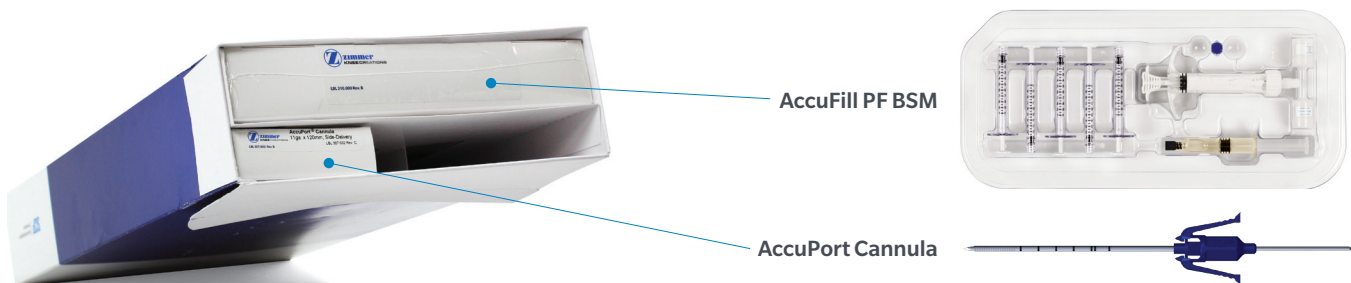

AccuFill PF BSM Mixing Technique

Hydrate:

1. Transfer the tray to the sterile field (back table). Remove the AccuFill PF BSM prefilled mixing syringe from tray. Pull on plunger tab to extend the stem completely from within the syringe.



Note: Before connecting the saline syringe, lightly tap on the full prefilled mixing syringe to loosen the AccuFill Powder, which can get compacted.

2. Remove and discard the plug from the prefilled mixing syringe.

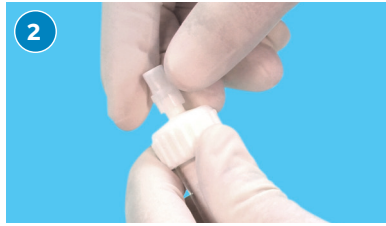

3. Remove the prefilled saline syringe from tray. Remove and discard the plug.

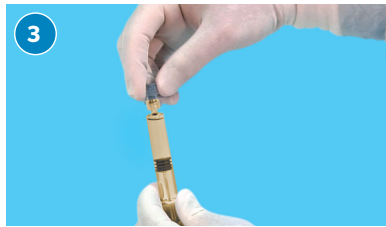

4. There is no need to expel air from the saline syringe. Holding the mixing syringe vertically, connect and tighten the saline syringe to the mixing syringe. See image for correct orientation.

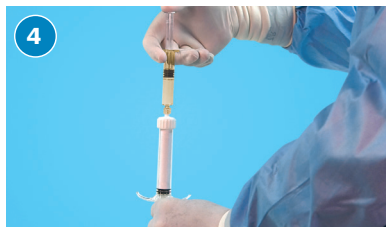

Note: To avoid expelling saline, do not expel air from the prefilled saline syringe.

5. Holding the syringes vertically, inject full volume of saline down into the mixing syringe (5a). Pull up on the saline syringe plunger to pull excess air into the syringe (5b). Inject again, to ensure **ALL SALINE FLOWS INTO POWDER (5c)**. Repeat to release pressure before removing saline syringe.

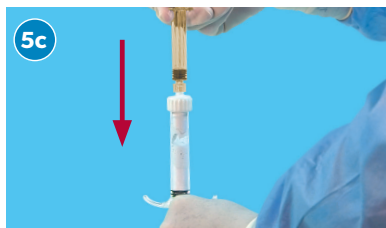
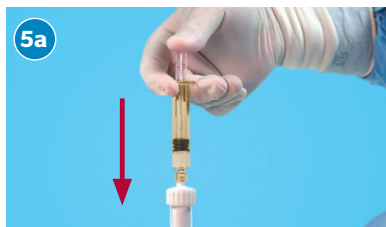

6. Attach and tighten the blue Luer lock plug onto the mixing syringe.

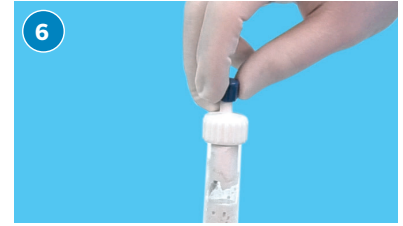

Mix:

7. Push the syringe plunger completely in and then pull back and push plunger through the full length of the cylinder to evenly distribute the saline and thoroughly wet the powder.

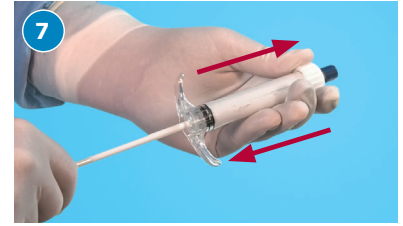

8. Repeatedly push, pull, and twist the plunger through the material in the syringe and continue for a minimum of 60 strokes/60 seconds. The material must be mixed completely.

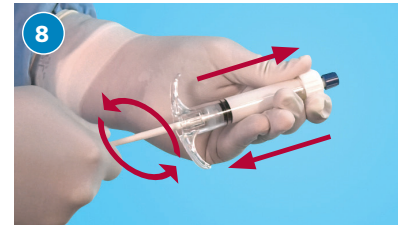

Note: Push and pull the plunger completely until it stops at each end of the syringe while twisting at least a quarter turn each time.

Note: Visually confirm through the syringe barrel that the material is being mixed completely. It will have a paste consistency.

9. After the material has been mixed thoroughly, pull on plunger tab to extend the stem fully from the mixing syringe and attach the plunger sleeve onto the stem.

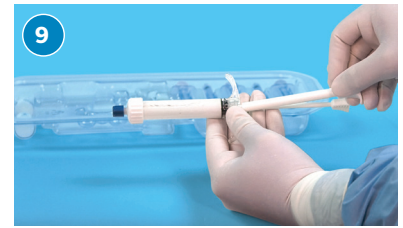

Transfer:

10. Remove the blue luer lock plug from the mixing syringe cap. Holding the mixing syringe with the white cap upright, expel excess air from the syringe. Connect the first 1 cc syringe. Inject AccuFill BSM into the syringe. Repeat for the remaining 1 cc syringes.



11. Transfer the filled 1 cc syringes to the operative field. Implant immediately for the best handling characteristics.

All content herein is protected by copyright, trademarks and other intellectual property rights, as applicable, owned by or licensed to Zimmer Biomet or its affiliates unless otherwise indicated, and must not be redistributed, duplicated or disclosed, in whole or in part, without the express written consent of Zimmer Biomet. Distribution to any other recipient is prohibited. For indications, contraindications, warnings, precautions, potential adverse effects and patient counseling information, see the package insert or contact your local representative; visit www.zimmerbiomet.com for additional product information. © 2021, 2022, 2023 Zimmer Biomet